

DATA SHEET

Arm Rest for Lateral Patient Positioning

Model : OT60.87



- For usage in lateral, prone, beach chair, and neuro parkbench positions
- Curved PUR upholstery to support arm better
- Includes clamp
- Rotatable and tiltable via ball joint

STANDARDS

| | |
|-----------------------|---------------------------|
| Classification | Class I |
| EU Conformity | Declaration of conformity |

PACKAGE DIMENSIONS (WxLxH)

400x800x130 mm - 30 kg

TECHNICAL DRAWING

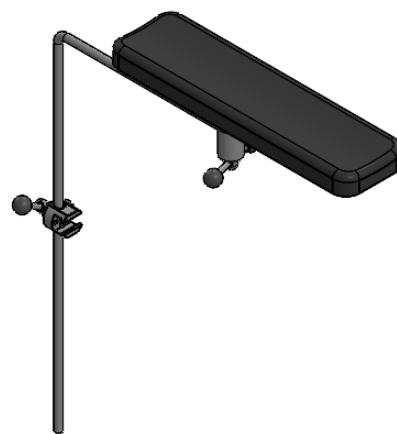
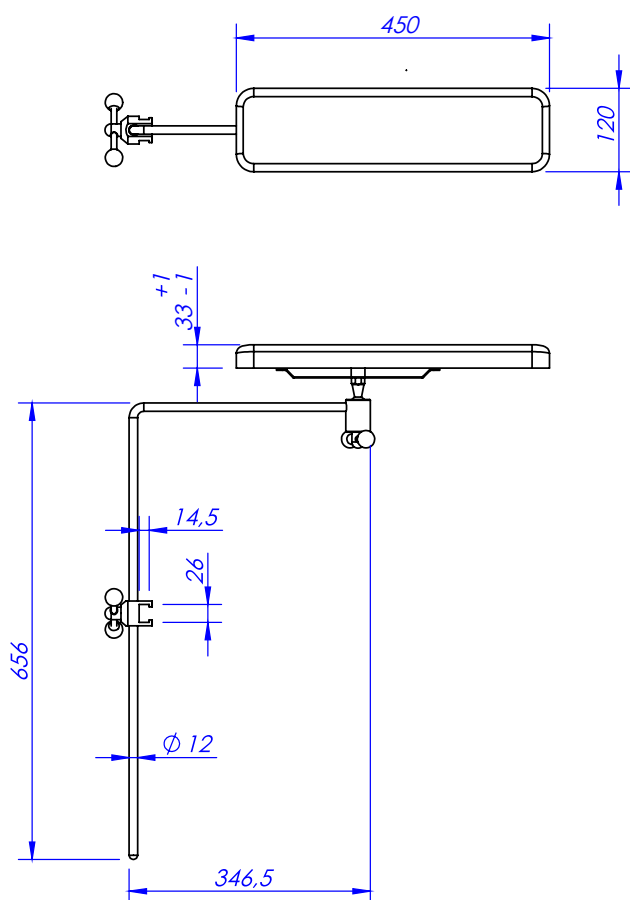

REV.01/07.25