



Inspital LED operating lights are designed to meet all lighting and viewing requirements of operating theatres. Powerful LED technology with high-tech camera option helps the surgeons to operate and view the surgery area clearly. LED lights can be adapted in any size of operating theatres including large hybrid types with variety of models & combinations.

STANDARDS

Classification Class 1 (MDD 93/42 EEC)

EU Conformity CE

Standards EN 60601-1, EN 60601-2-41

PACKAGE DIMENSIONS

100x120x180 cm - 210 kg

MATERIAL SPECIFICATIONS

Lamp Head Static Painted (RAL 9002) Aluminum / Polycarbonate

Joint Handle Static Painted (RAL 9002) Aluminum

Sterile Handle Plastic (ABS + PC)

The handle should be sterilized at 134 °C between 3.5-5 minutes and at 121°C during 10 minutes.

TECHNICAL SPECIFICATIONS

| | |
|---|---------------------------------|
| Diameter of lighthouse with outer handle | Ø670 mm |
| Illumination power, at 1 m | 160.000 Lux |
| Color temperature (adjustable) | 3000 K - 5000 K |
| Color rendering index, Ra CRI | 96% |
| Dimming Range (adjustable) | % 1 – 100 |
| Light Field Diameter d10 | 24 - 36 cm/9.5"-14.2" |
| Light Field Diameter d50 | 13 - 28 cm/5.1"-11" |
| Number of LED modules | 60 |
| Lifetime of LED | >60.000 h |
| IP | IP 43 |
| Total power consumption (max) | 290 W |
| Degree of turbulence(standard value 37.5% max.) | 29% |
| Irradiance at nominal illuminance | 510 W/m ² |
| UV radiation intensity | 0,2 W/m ² |
| Depth of the volume of light L1 + L2 at 20% | 130 cm / 51.2" |
| Input Voltage | 220-240 VAC / 50-60 Hz |
| Depth of Lightning (L1+L2) at 60% | 76 cm/30" |
| Weight of light head | 13.2 kg |
| Additional options | Wall Control Panel, UPS, Camera |

TECHNICAL DRAWING

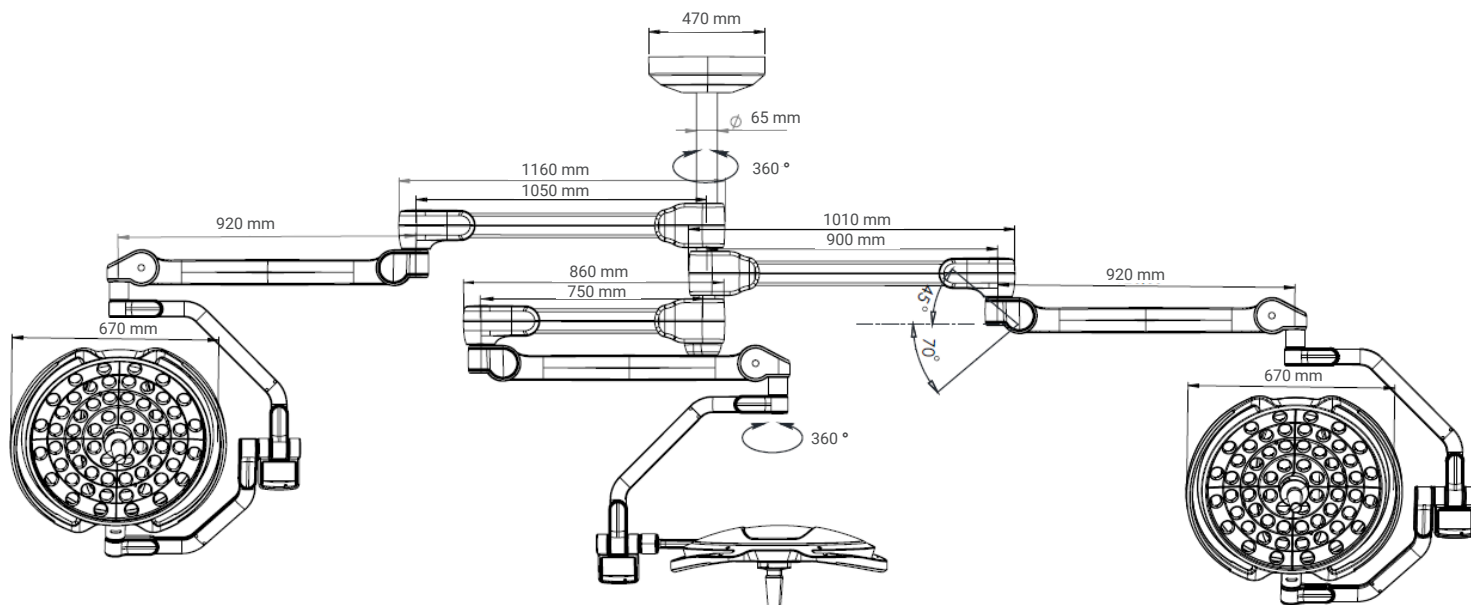

Note: ± 25 mm tolerance is given for metric measurements and ± 5° tolerance is given for angle measurements.

REV.01/03.25

OTHER SPECIFICATIONS



Active Illumination Control (AIC)

Inspital LED light technology provides the best illumination, even when surgeons are blocking the LEDs. The loss of illumination when certain LEDs are obstructed is automatically compensated by the AIC system.

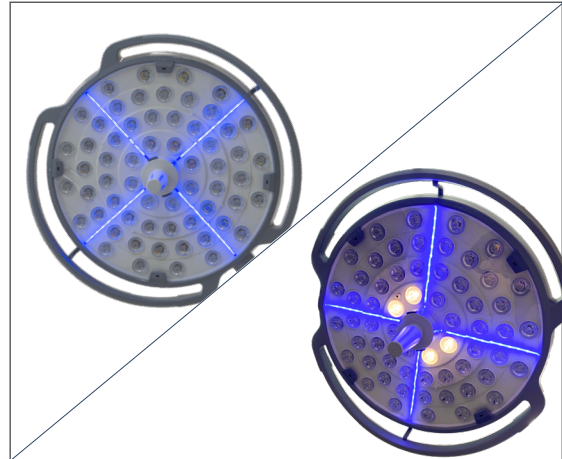

StandBy Mode/ Endo Light Mode

Stylish blue LED strips in standby mode. Endo light mode can be activated with one touch, switching immediately and ready for endoscopic procedures.



Laser Positioning Guide

Each light head has a laser guide to easily and efficiently position the lighting center.

Auto Light Feature

When the Auto Light feature is activated, the light intensity at the center remains constant at any height, angle or obstacle using the PID method.



Touch Screen Control Unit

User friendly 4.3" LCD touch screen unit is used to easily control all functions by tapping and swiping the icons.