



Inspital LED operating lights are designed to meet all lighting and viewing requirements of operating theatres. Powerful LED technology with high-tech camera option helps the surgeons to operate and view the surgery area clearly. LED lights can be adapted in any size of operating theatres including large hybrid types with variety of models & combinations.

STANDARDS

Classification	Class 1 (MDD 93/42 EEC)
EU Conformity	CE
Standards	EN 60601-1, EN 60601-2-41

PACKAGE DIMENSIONS

100x175x70 cm - 130 kg

MATERIAL SPECIFICATIONS

Lamp Head	Static Painted (RAL 9002) Aluminum / Polycarbonate
Joint Handle	Static Painted (RAL 9002) Aluminum
Sterile Handle	Plastic (ABS + PC)

The handle should be sterilized at 134 °C between 3.5-5 minutes and at 121°C during 10 minutes.

TECHNICAL SPECIFICATIONS

Diameter of lighthouse with outer handle	Ø490 mm
Illumination power, at 1 m	120.000 Lux
Color temperature (adjustable)	3000 K - 5000 K
Color rendering index, Ra CRI	96%
Dimming Range (adjustable)	% 1 – 100
Light Field Diameter d10	25 - 27 cm/9.45"-10.63"
Light Field Diameter d50	12 - 14 cm/4.7"-5.5"
Number of LED modules	28
Lifetime of LED	>60.000 h
IP	IP 43
Total power consumption (max)	55 W
Degree of turbulence(standard value 37.5% max.)	25%
Irradiance at nominal illuminance	430 W/m ²
UV radiation intensity	0,2 W/m ²
Depth of the volume of light L1 + L2 at 20%	185 cm / 72.8"
Depth of the volume of light L1 + L2 at 60%	92 cm/36.2"
Input Voltage	220-240 VAC / 50-60 Hz
Weight of light head	9 kg
Battery	Backup system provides 2,5 hours of energy

TECHNICAL DRAWING

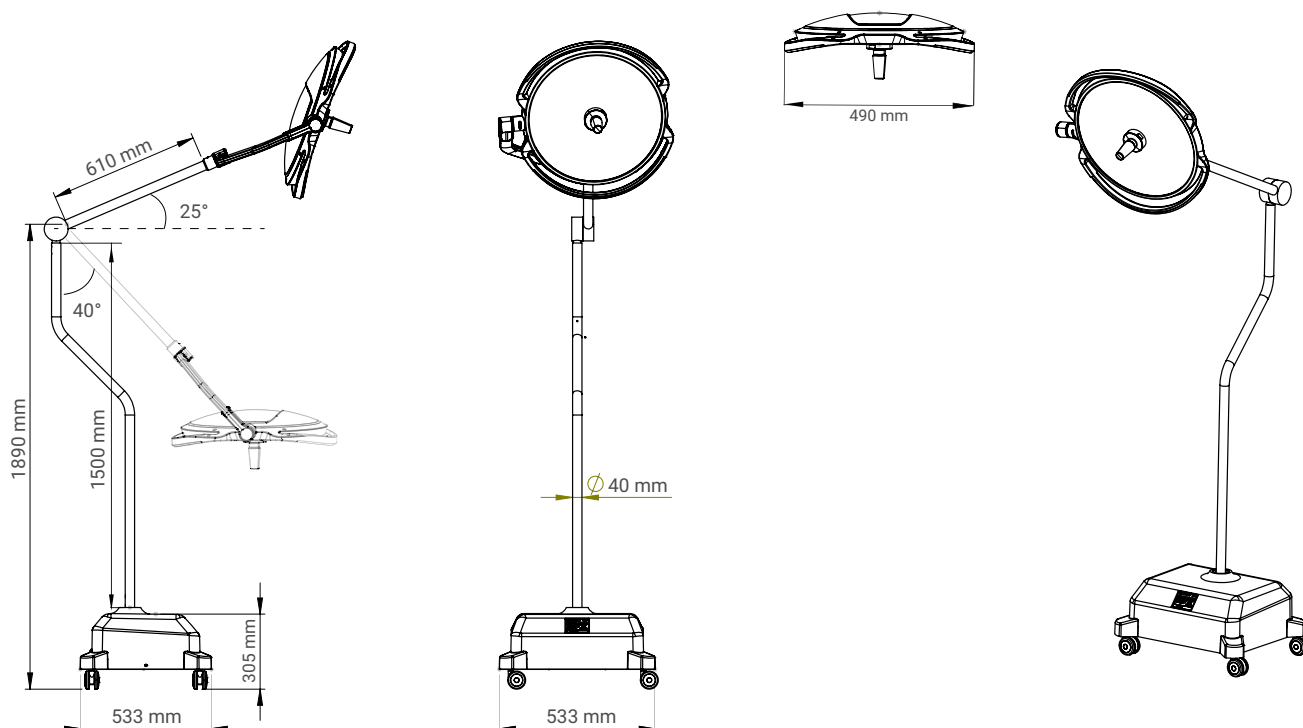

Note: ± 25 mm tolerance is given for metric measurements and ± 5° tolerance is given for angle measurements.

REV.01/03.25